

Lunar Base Assembly Guide

Lunar Base A

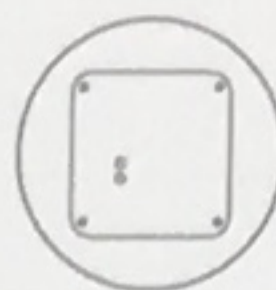

Lunar Base B



Screw



Hex Key



Calibration Weight



1 Turn Lunar Over

Turn over the scale and place it on a flat surface.

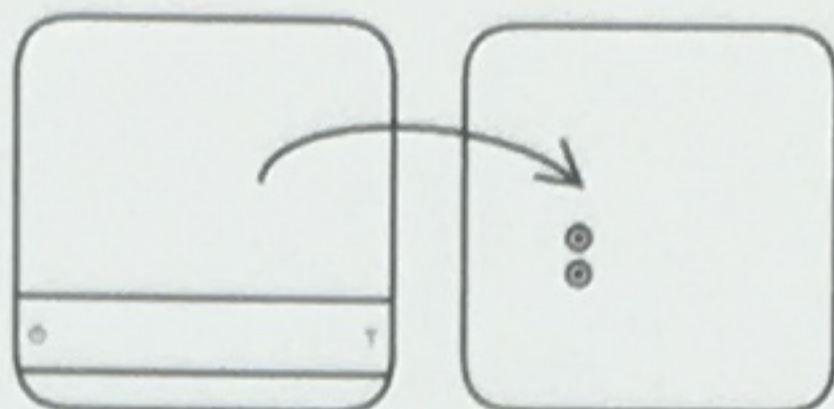

2 Remove Original Base Plate

Unscrew the two screws with the hex key and remove the original base plate and spacer.

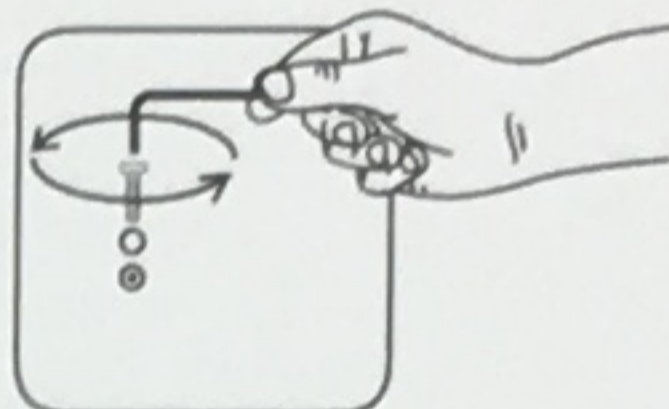

anticlockwise

3 Install the Lunar Base A

Replace the original base plate with the Lunar Base A, insert two new screws and tighten with hex key.

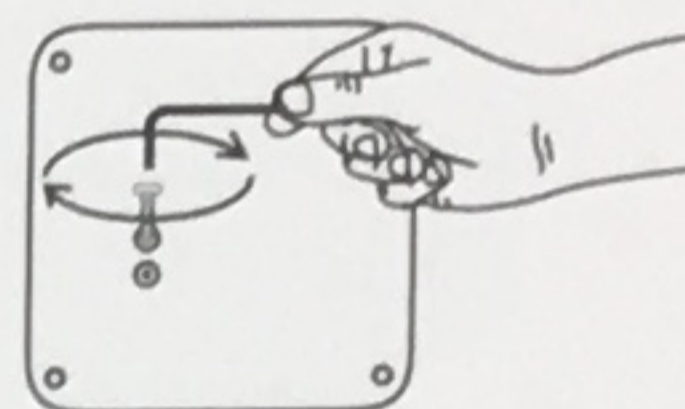

clockwise

4 Check Alignment

Make sure that the Lunar Base A is evenly positioned in the center and screws are secured.

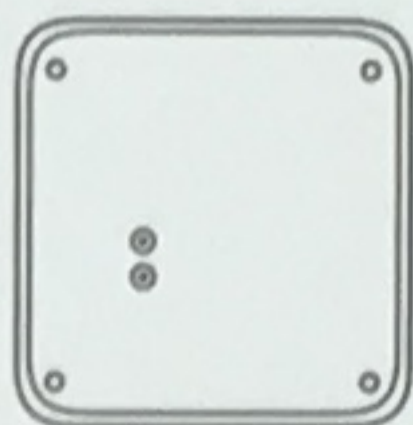

5 Apply Lunar Base B

Place Lunar Base B on Lunar Base A and assemble with the remaining screws.

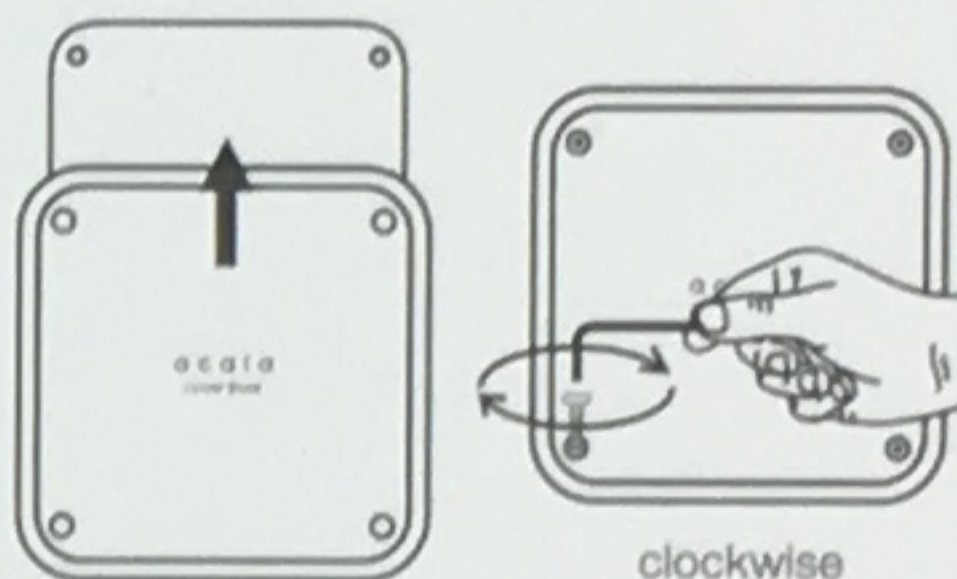

clockwise

6 Calibration

Use the 100g calibration weight that comes with the Lunar to calibrate.



acaia